

# Test Lab Demolition Phase Planning

- Have Restarted the Project (Fresh Start)
  - New Project Manager
  - Pre-construction conference for this phase
  - All workers are currently repeating Mortenson Safety Training
- Demolition Plan has been approved
- AHAs have been approved
- Asbestos Abatement Plan Approved
- Contractor completed a baseline air monitoring
- Meeting twice weekly to review utilities plus a weekly mechanical/electrical coordination meeting

# Mortenson AHA Checklist

Jefferson Lab TEDF 2  
AHA Review Checklist - 5/15/12



Yes No NA PPE

- Standard PPE identified (hard hats, safety glasses, high visibility vest, gloves, composite / steel toed boots)
- Are the gloves appropriate for the task?
- Is hearing protection required for this task?
- Is fall protection required for this task? If so, how will it be achieved?
- Is a respiratory required while completing this task? If so, what type? Has fit testing and doctor qualification been completed for each individual performing the task? Is it on file?

## Tools and Equipment

- Are tools identified for the Task to be completed?
- Are training requirements for the task or tools to be used identified?
- Are equipment inspections required? Have they been identified?
- Do we have MSDS sheets for material to be used?

## The People

- Are competent persons identified?
- Do you have the operator certs and qualifications?
- Is a spotter required while completing the task?

## Digging and Penetrations

- Is a digging or penetration permit required?

## Flammables

- Does a burn permit need to be issued?
- If acetylene used, are bottles secured and separated properly?

- Is a fire extinguisher going to be at the work area?
- Is a 30 minute fire watch identified?
- Is extra fire protection (i.e. - fire blankets) required?

## Air Quality

- Does a silica disturbance permit need to be issued?
- Have the MSDS sheet been reviewed for proper PPE?
- Are proper engineered controls planned for during completion of the task?
- If welding, have exhausting fumes been addressed? Have alarms been deactivated or being monitored?

## Live Utility Awareness

- Is a live utility awareness permit required?
- Do we need a shutdown to safely complete the task?
- Have we communicated with the Customer any conflicts with existing utilities?

## Task Specific Items

- \_\_\_\_\_
- \_\_\_\_\_
- \_\_\_\_\_
- \_\_\_\_\_
- \_\_\_\_\_
- \_\_\_\_\_
- \_\_\_\_\_

# Demolition Protocol

- Construction Areas will be designated; no JSA staff in construction areas during demolition
- Test Lab will be secured with new keying
- Those entering construction area during demolition will have proper PPE; including respirator as required
- Utilities will be secured in the construction area prior to demolition
- Demolition will be monitored by the TEDF project Team and EH&S/Industrial Hygiene
- Area will be cleared by EH&S prior to JSA work restarting work in the Test Lab

# Test Lab Demolition 1<sup>st</sup> Floor

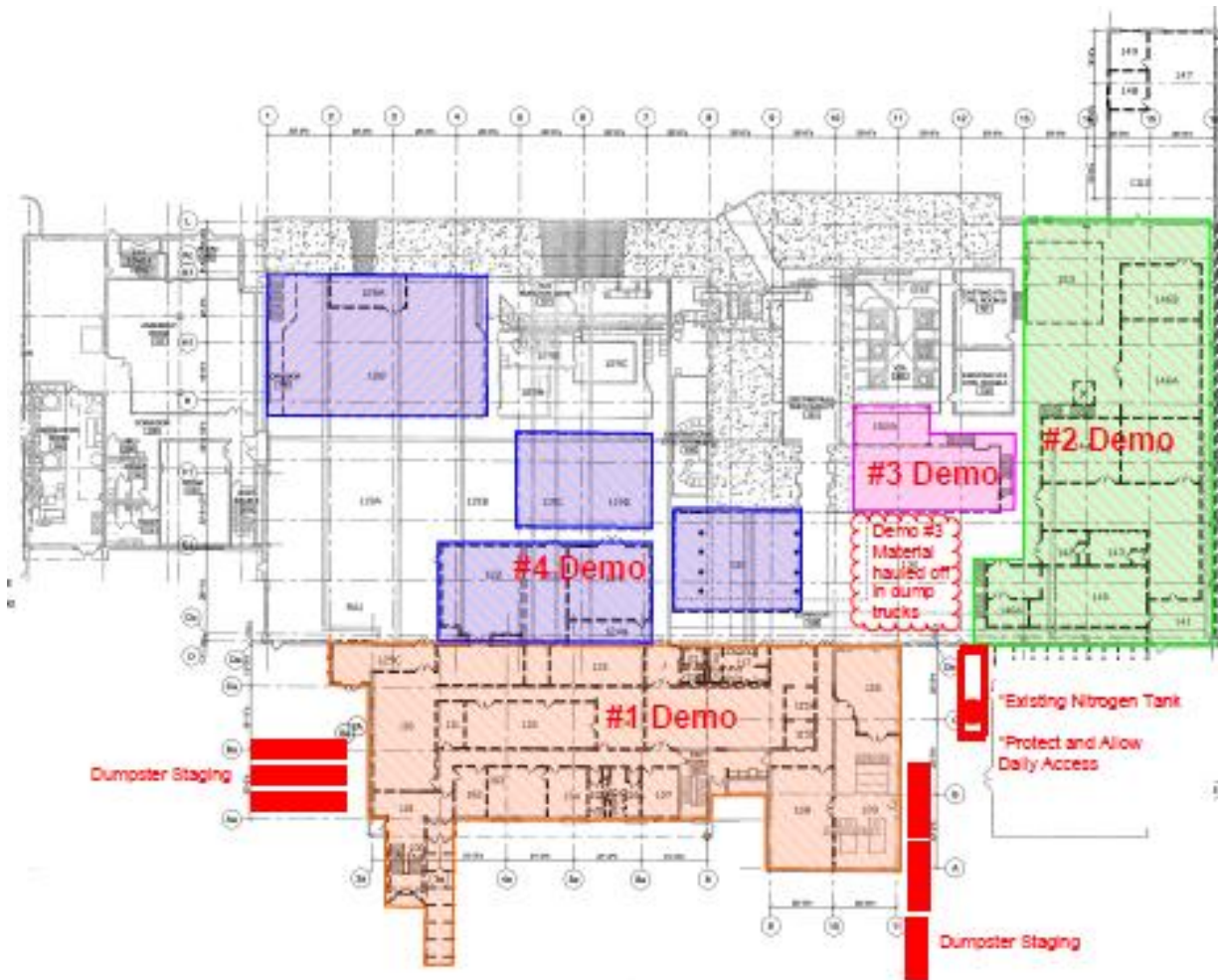

- Starting with the west office wing
- High Bay – start with the south end moving north
- #3 is the large concrete mass to be removed

# Test Lab Demolition 2<sup>nd</sup> Floor

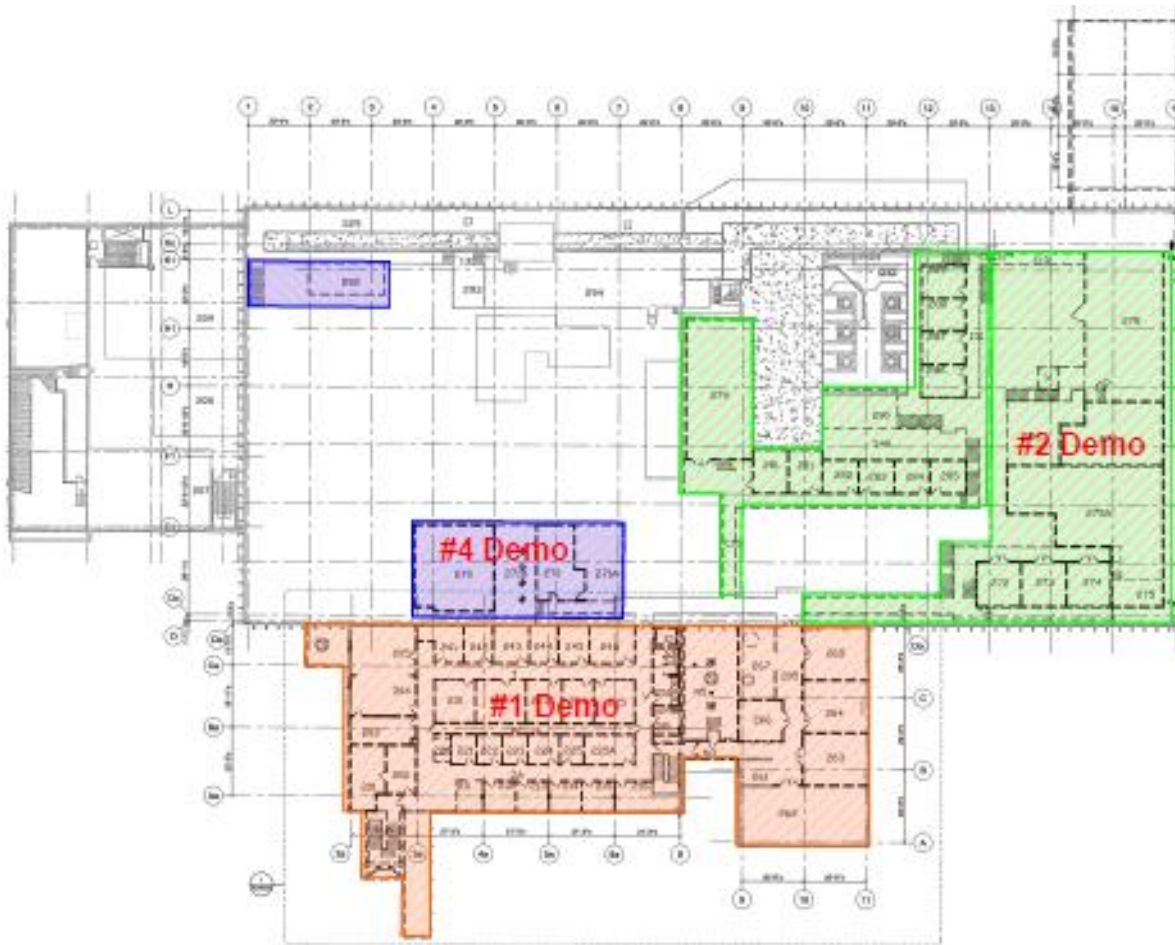

- Clean room and structures above test cave must be removed before major concrete demolition
- Est. 300 40 cy dumpsters of debris will be removed

# Test Lab Demolition 3<sup>rd</sup> Floor

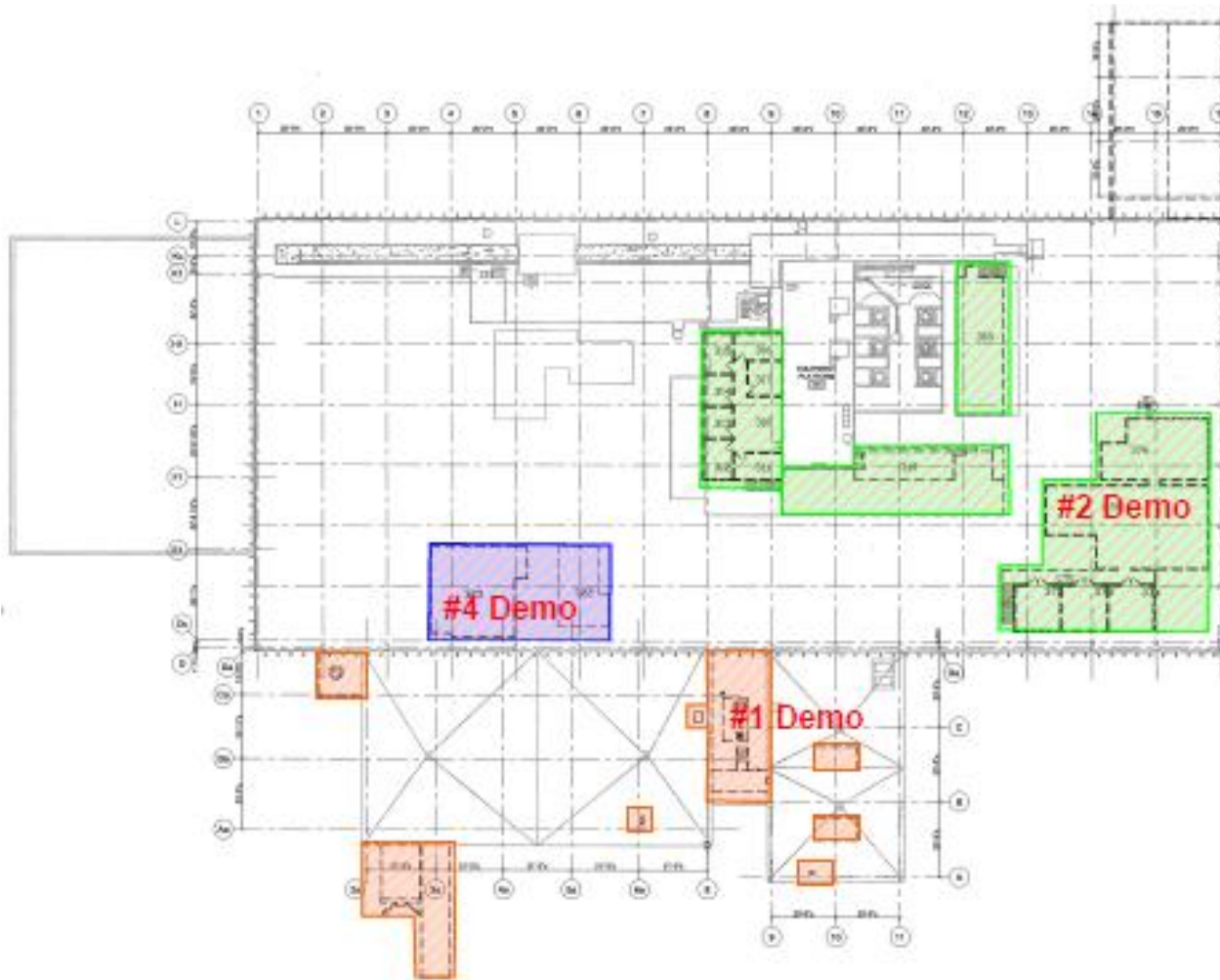

- VTA and Test Cave Equipment will be protected during demolition

# Demolition Key Dates

Starting Week of	Demolition Activity
29 May 12	West Wing 2 <sup>nd</sup> floor office area
4 June 12	West Wing 2 <sup>nd</sup> floor shop area
11 June 12	West Wing 1 <sup>st</sup> floor High Bay South Cleanrooms
25 June 12	All Lab activity out of Test Lab; major demolition starts in High Bay.
After 6-8 weeks	Limited use of VTA and Test Cave

# Safe Access Btw TED and TLA

